



**DESIGN & CONSTRUCTION GROUP  
THE GOVERNOR NELSON A. ROCKEFELLER  
EMPIRE STATE PLAZA  
ALBANY, NY 12242**

---

**ADDENDUM NO. 5 TO PROJECT NO. Q1909**

**CONSTRUCTION AND ELECTRICAL WORK  
REPLACE PERIMETER DETECTION AND CAMERA SYSTEMS  
ALBION CORRECTIONAL FACILITY  
3595 STATE SCHOOL ROAD  
ALBION, NY**

March 6, 2026

**NOTE:** This Addendum forms a part of the Contract Documents. Insert it in the Project Manual. Acknowledge receipt of this Addendum in the space provided on the Bid Form.

**ELECTRICAL WORK SPECIFICATIONS**

1. SECTION 017900.02 - VIDEO TRAINING PROGRAMS, Paragraph 1.1.F: Remove in its entirety and replace with:  
“F. Perimeter Video Surveillance System: Section 282315.”
2. SECTION 017900.02 - VIDEO TRAINING PROGRAMS, Paragraph 1.2.A, Add the following subparagraph:  
“2. Training programs are required for the systems in the following Specification Sections:  
a. Intercom System: Section 275111  
b. Perimeter Security Multiplex System: Section 281603  
c. Microwave Detection System: Section 281604  
d. Sensor Cable Detection System: Section 281605  
e. Perimeter Video Surveillance System: Section 282315”
3. SECTION 281603 - PERIMETER SECURITY MULTIPLEX SYSTEM, Paragraph 2.2.13: Remove in its entirety and replace with:  
“13. Manufactured type: D-Link Model DGS-3630-28PC or approved equal”
4. SECTION 281605 - SENSOR CABLE DETECTION SYSTEM, Paragraph 1.5.A: Remove in its entirety and replace with:  
“A. Spare Parts:  
1. Six fuses.  
2. Package of 100 cable ties.  
3. Six rechargeable batteries for Wireless Gate Sensor.”
5. SECTION 282315 - PERIMETER VIDEO SURVEILLANCE SYSTEM, Paragraph 2.9.13.a: Remove in its entirety and replace with:  
“a. D-Link Model DGS-3630-52PC or approved equal.”

**ELECTRICAL DRAWINGS**

6. Revised Drawing:
  - a. Drawing Nos. ES-312, ES-504, noted ADDENDUM 5 dated 03/03/2026, accompanies this Addendum and supersedes the same numbered previously issued drawing.

**END OF ADDENDUM**

Brady M. Sherlock, P.E.  
Director, Division of Design  
Design & Construction

**FIBER PULL BOX CABLING IDENTIFICATION**

- C1. 72 STRAND FEED FIBER FROM EER TO THIS FAS
- C2. 72 STRAND FEED FIBER FROM EER BYPASS TO NEXT FAS
- C3. 12 STRAND FIBER FROM PREVIOUS COYOTE TO THIS FAS
- C4. 12 STRAND FIBER THIS COYOTE TO PREVIOUS FAS
- C5. 12 STRAND FIBER THIS COYOTE TO NEXT FAS
- C6. 12 STRAND FIBER PREVIOUS COYOTE TO THIS FAS

ELAN CABLES FOR CAMERAS AND OTHER SECURITY DEVICES PASS THROUGH FIBER PULL BOXES. REFER TO FAS RISER ON THIS DRAWING FOR DETAILS. ALL FIBER CABLING MUST LOOP INSIDE THE PULL BOX MINIMUM OF 1 ROTATION

- A = 2 STRAND SFO
  - B = 2#12 DC POWER CABLE
  - C = 12 STRAND SFO
  - D = 72 STRAND SFO
  - E = ELAN CABLE
  - F = 6#18 MW CABLE
- $\overline{TM}$  = SATELLITE ENCLOSURE TAMPER  
 $\overline{2,2,8}$  = AXIS I/O MODULE  
 $\overline{1}$  = I/O IDENTIFICATION  
 $\overline{1}$  = I/O INPUT NUMBER

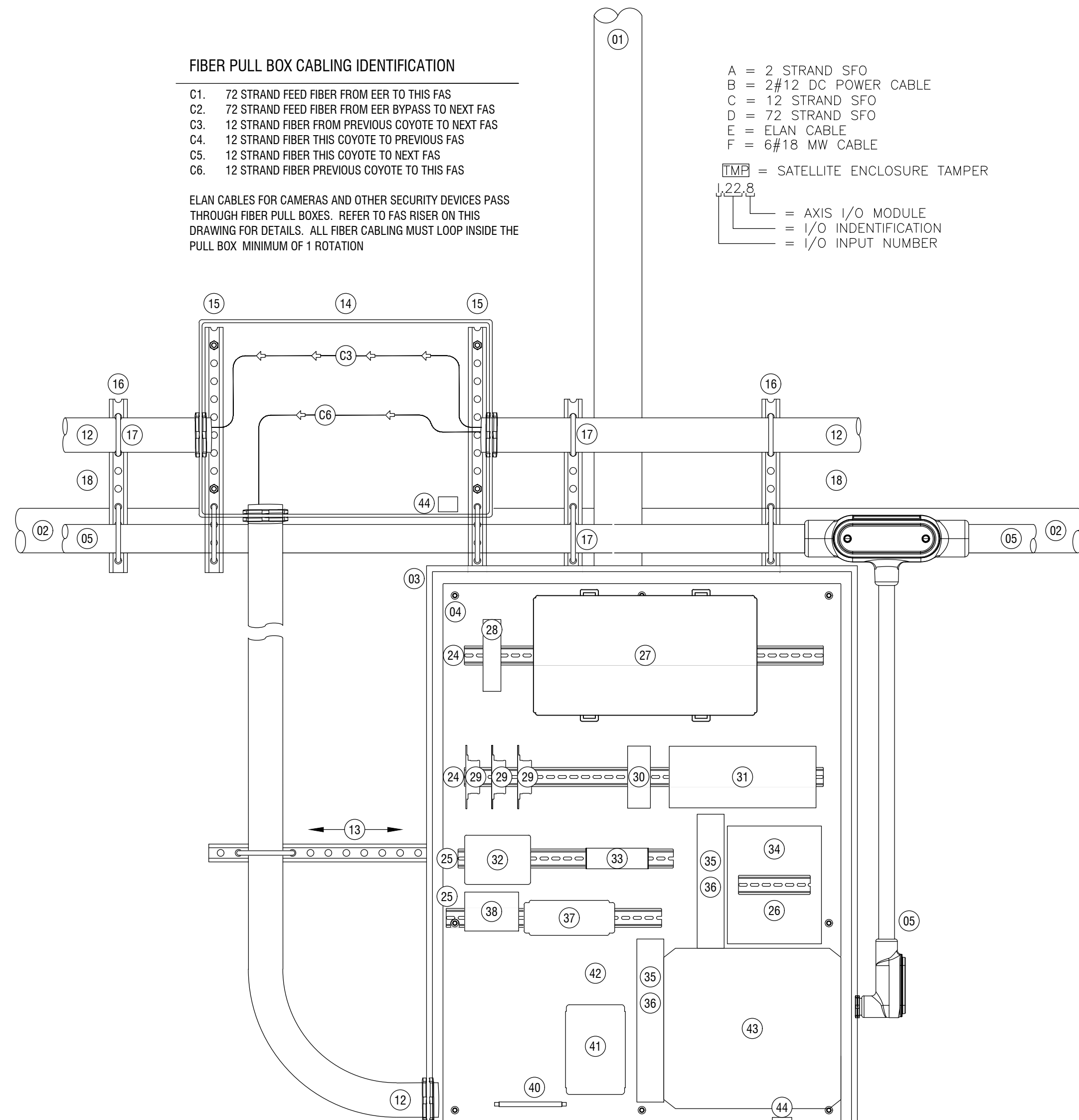

ID #	FAS DEVICE IDENTIFICATION - PROVIDE UNLESS OTHERWISE NOTED
1	VERTICAL FENCE POLE (E)
2	HORIZONTAL FENCE POLE (E)
3	FAS ENCLOSURE 48"H X 36"W X 12"D (E)
4	FAS ENCLOSURE BACK PANEL 45"H X 33"W
5	FAS ENCLOSURE POWER FROM LIGHTING CIRCUIT (E)
6	STAINLESS STEEL NEMA 4X BREATHER/DRAIN
7	FAS CONDUIT TO CAMERA, FENCE SYSTEM OR INTERCOM DEVICE (E)
8	FAS CONDUIT TO EARTH GROUND (E)
9	GROUNDING DETAIL, INSTALL IF IT DOES NOT EXIST
10	CHANNEL SUPPORT SYSTEM FOR FAS ENCLOSURE (E) (TYPICAL OF 2)
11	SECURE CONDUITS TO CHANNEL SYSTEM WITH GALVANIZED CLAMPS (TYP.)
12	FAS 2" FIBER RIGID CONDUIT FOR SFO, MAINTAIN AN 8 INCH BEND RADIUS
13	CONDUIT CHANNEL SUPPORT BOLT TO EXISTING SUPPORT AS REQUIRED
14	FENCE PULL BOX 16.5" X 24.5" MINIMUM
15	PULL BOX CHANNEL SUPPORT BOLT AROUND FENCE POLE/POWER CONDUIT
16	CONDUIT CHANNEL SUPPORT BOLT AROUND FENCE POLE/POWER CONDUIT
17	U-BOLT FOR CONDUIT CHANNEL SUPPORT (TYPICAL)
18	VERIFY DISTANCE SO FIBER CONDUIT CLEARS LIGHTING PULL BOX
19	NON-PROTECTED CAT-6 FROM TOWER 112
20	OMNI ANTENNA WIRE GLAND
21	SENSTAR FLEXZONE OMNI ANTENNA CABLE, SECURE TO FENCE POLE
22	SENSTAR FLEXZONE GATE SENSOR ANTENNA CABLE PULL BOX
23	SENSTAR FLEXZONE WIRELESS GATE SENSOR OMNI ANTENNA
24	30" - 3.5MM DIN RAIL
25	18" - 3.5MM DIN RAIL
26	6" - 3.5MM DIN RAIL
27	19" X 10" COYOTE RUNT 8006951 FIBER SPLICE BOX
28	OPTICAL FIBER DISTRIBUTION PANEL (OFDP)
29	SINGLE CHANNEL FIBER MEDIA CONVERTER
30	COMNET MORD48480 48V 10AMP POWER SUPPLY
31	EATON DINSS502C DIN RAIL MOUNT UPS
32	AXIS A9210 10 INPUT/1-OUTPUT I/O MODULE
33	48-53V DC DISTRIBUTION TERMINALS
34	NEW 120V PULL BOX AND ELEC PANELBOARD
35	PANDUIT 2.25" X 4" SHIELDED WIRING DUCT
36	PANDUIT SHIELDED WIRING DUCT SEPARATION RAIL (TYP)
37	CAMERA/DEVICE SURGE PROTECTION (CSP)
38	ENCLOSURE HIGH/LOW AIR TEMP ALARM
39	SENSTAR FLEXZONE PROCESSOR
40	ELECTRODE ROD GROUNDING TERMINALS
41	HOFFMAN HEATER UNIT
42	HOFFMAN HEAT DISSIPATION AREA
43	NEW OR EXISTING 480V SQUARE D TRANSFORMER/DISCONNECT
44	NASCOM N505 ENCLOSURE TAMPER ALARM FAS AND FIBER PULL BOX
45	DITEK 480V SURGE PROTECTION (CUT/REMOVE FINGER DUCT)
46	120V AC POWER HOT TERMINALS
47	120V AC POWER NEUTRAL TERMINALS
48	120V AC POWER GROUND TERMINALS
49	S/O POWER CABLE FEED TO UPS MAIN POWER INPUT
50	S/O UPS POWER CABLE FEED TO MINI-BREAKERS
51	S/O UPS POWER HOT OUTPUT FEED CABLE (NEU. TO 47, GND TO 48)
52	120V AC POWER MINI-BREAKER (4)
53	120V AC HOT BRKR TO HEATER (NEU. TO 47, GND TO 48)
54	120V AC HOT BRKR TO MORD48480 PWR SUP (NEU. TO 47, GND TO 48)
55	O/I SERVICE OUTLET ON DISCONNECT
56	S/O UPS POWER TO 48V POWER INPUT
57	16AWG POWER TO 48V POWER TERMINAL INPUT
58	POWER TO FMC SECURITY DEVICES 1-4, (ALTERNATE POWER JUMPS)
59	POWER TO FMC SECURITY DEVICE 5-8, (ALTERNATE POWER JUMPS)
60	12 OR 72 SFO FIBER CABLE
61	12 SFO TO OPTICAL FIBER DISTRIBUTION PANEL
62	2 SFO (EA) TO POE FIBER MEDIA CONVERTER
63	NON-PROTECTED CAT-6 FROM FIELD
64	SURGE PROTECTED CAT-6 CSP 3" MINIMUM JUMPER TO FMC OR POE SWITCH
65	FIBER FROM OFDP DIRECTLY TO POE SWITCH OR FPM
66	AXIS NETWORK COMMUNICATION PORT
67	SFO FENCE PROCESSOR FIBER COMMUNICATION MODULE
68	SENSTAR FLEXZONE WIRELESS GATE SENSOR MODULE
69	SCREW DOWN TIEWRAP HOLDER (TYP)
70	SCREW DOWN TIEWRAP HOLDER SHOWN W/TIEWRAP (TYP)
71	EATON DINSS502C UPS REMOTE ON/OFF/RESET TO AXIS I/O
72	INTERCOM POE NETWORK SWITCH
73	SURGE PROTECTED CIRCUIT
74	FUTURE O/I SERVICE OUTLET ON DISCONNECT
75	SURGE SUPPRESSOR FOR 24VDC FPM AND MICROWAVE POWER
76	SURGE SUPPRESSOR FOR ULTRAWAVE ALARM & TROUBLE CIRCUIT
77	24VDC FROM CONSOLE MPSPS TO FPM AND MICROWAVE VIA SURGE

ENCLOSURE SIZE: 48"H X 36"W X 12"D (03)  
 PANEL SIZE: 45"H X 33"W (04)

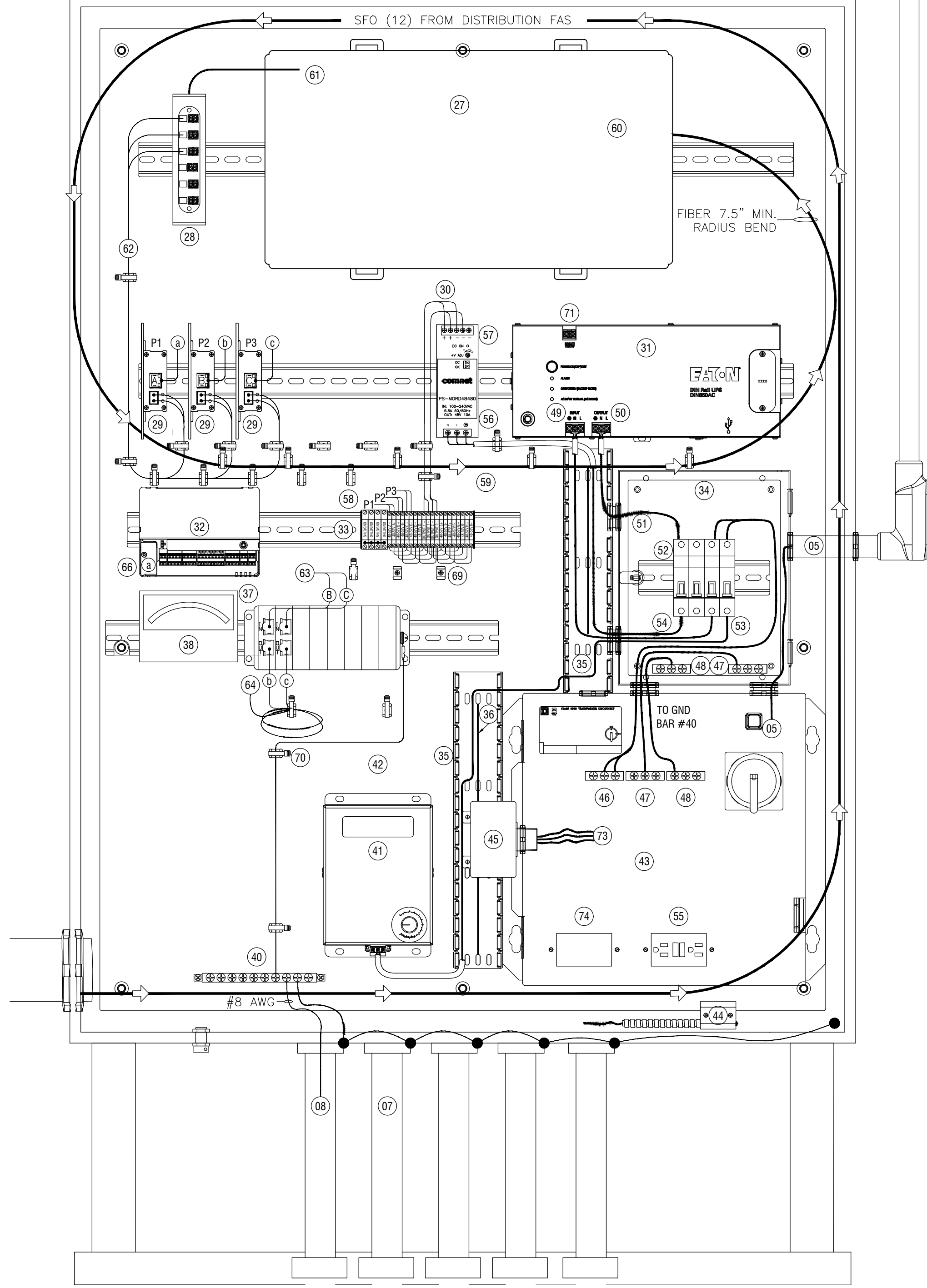

**FENCE ACCESSORY STATION ENCLOSURE "R"**  
 SCALE: 3" = 1'-0"

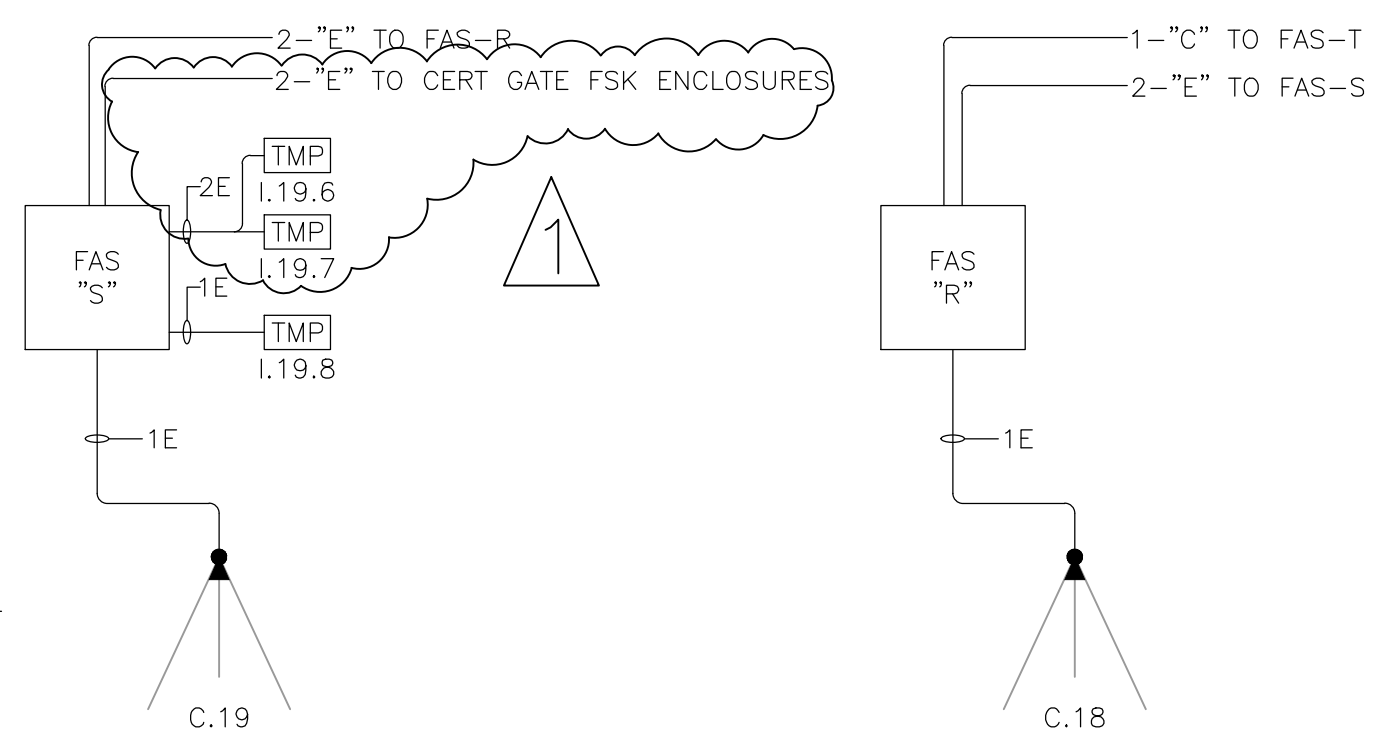

**FENCE ACCESSORY STATION "S" & "R" RISER**  
 SCALE: NOT TO SCALE

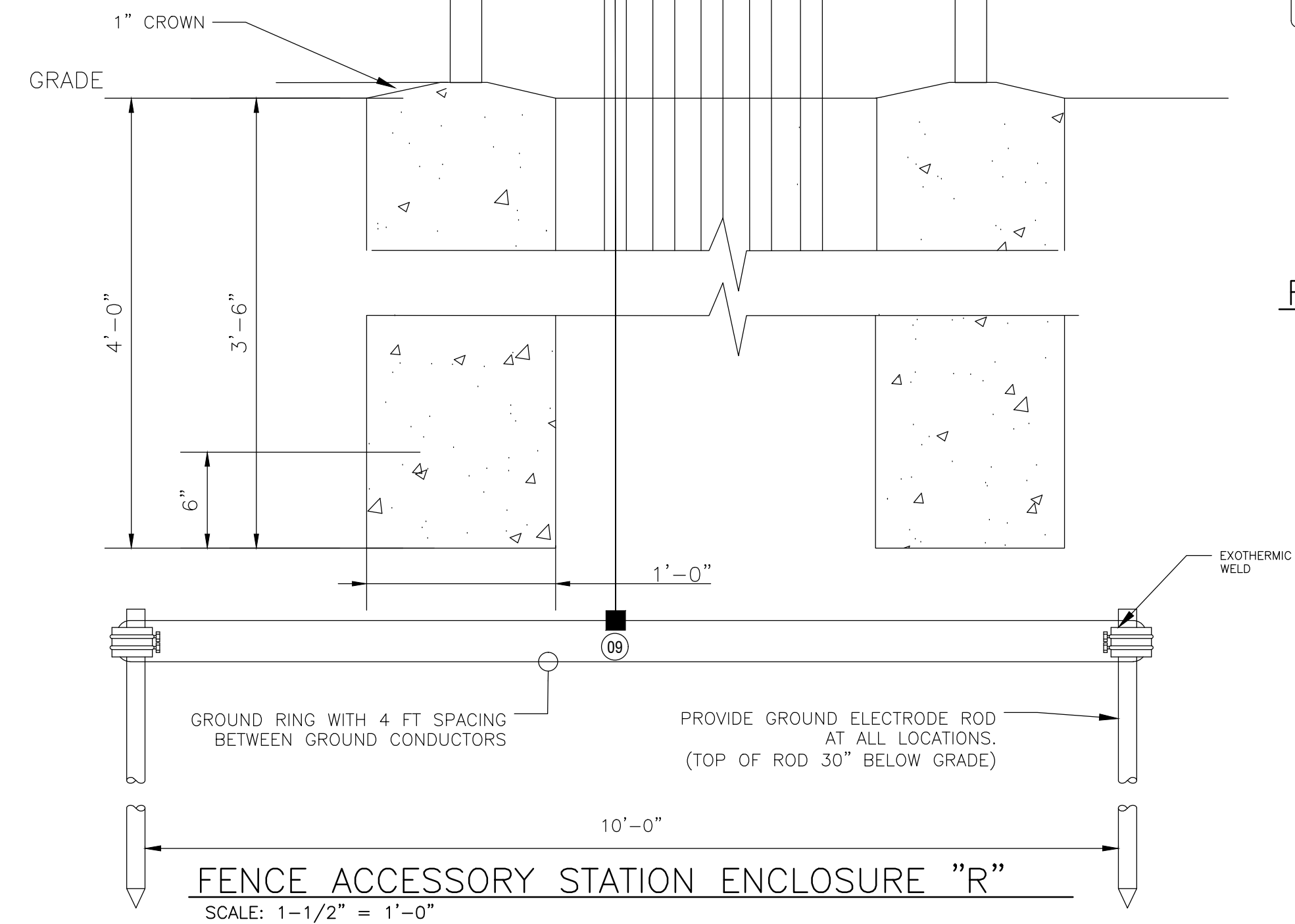

**FENCE ACCESSORY STATION ENCLOSURE "R"**  
 SCALE: 1-1/2" = 1'-0"

**GENERAL NOTES:**

1. SEAL ALL CONDUITS WITH DUCT-SEAL AFTER CABLE INSTALLATION AND REMOVAL WORK IS COMPLETE.
2. REPLACE DOOR SEALING GASKET WITH SELF-ADHESIVE, NEOPRENE BLEND GASKET DESIGNED FOR NEMA 4X ENCLOSURES. MATCH WIDTH OF EXISTING GASKET.
3. REMOVE EXISTING DISCONNECT AND GFI RECEPTACLE AND BACK BOX.
4. REMOVE SINGLE RECEPTACLE IN PANELS WHERE IT EXIST.
5. REMOVE PELCO RECEIVER DRIVER CONTROL UNITS WHERE IT EXIST.
6. REMOVE FENCE PERIMETER CONTROLLER MODULES IN PANELS WHERE IT EXIST.
7. REMOVE EXISTING LIGHTNING SURGE PROTECTION IN PANELS WHERE IT EXIST.
8. REMOVE EXISTING CONDUITS AFTER FAS PANELS HAVE BEEN CUT-OVER AND ACCEPTED.
9. REPAIR OR REPORT ANY NOTICEABLE LEAKS IN FAS ENCLOSURE.
10. VERIFY THE INTEGRITY OF ANY GASKETS ON THE FAS ENCLOSURE SIDE WALLS.
11. REPLACE BACKPLANE WITH PRE-POPULATED BACKPLANE

DESIGN & CONSTRUCTION

CONSULTANT

**LaBella**  
 Powered by partnership.

300 State Street, Suite 201  
 Rochester, NY 14614

**WARNING:**

IT IS A VIOLATION OF NEW YORK EDUCATION LAW ART. 145 SEC. 7209 & ART. 147 SEC. 7307, FOR ANY PERSON, UNLESS ACTING UNDER THE DIRECTION OF A LICENSED ARCHITECT, PROFESSIONAL ENGINEER, OR LAND SURVEYOR, TO ALTER AN ITEM IN ANY WAY, IF AN ITEM BEARING THE SEAL OF AN ARCHITECT, ENGINEER, OR LAND SURVEYOR IS ALTERED; THE ALTERING ARCHITECT, ENGINEER, OR LAND SURVEYOR SHALL AFFIX TO THE ITEM THEIR SEAL AND NOTATION "ALTERED BY" FOLLOWED BY THEIR SIGNATURE AND DATE OF SUCH ALTERATION, AND A SPECIFIC DESCRIPTION OF THE ALTERATION.

EXP: 06/30/2027

CERTIFICATE OF AUTHORIZATION NUMBER:  
 PROFESSIONAL ENGINEERING: 0021272

CONTRACT:

**ELECTRICAL**

TITLE:  
 REPLACE PERIMETER DETECTION & CAMERA SYSTEMS

LOCATION:  
 ALBION CORRECTIONAL FACILITY  
 3595 STATE SCHOOL ROAD  
 ALBION, NEW YORK

CLIENT:  
 DEPARTMENT OF CORRECTIONS  
 AND COMMUNITY SUPERVISION

MARK	DATE	DESCRIPTION
Δ	03/03/2026	ADDENDUM 5
	01/09/2026	BID DOCUMENT
PROJECT NUMBER:	Q1909 - E	
DESIGNED BY:	MJP	
DRAWN BY:	MJP	
FIELD CHECK:		
APPROVED:		
SHEET TITLE:	FENCE ACCESSORY STATION (FAS) ENCLOSURE "R"	
DRAWING NUMBER:	ES-312	

**WARNING:**

IT IS A VIOLATION OF NEW YORK EDUCATION LAW ART. 145 SEC. 7209 & ART. 147 SEC. 7307, FOR ANY PERSON, UNLESS ACTING UNDER THE DIRECTION OF A LICENSED ARCHITECT, PROFESSIONAL ENGINEER, OR LAND SURVEYOR, TO ALTER AN ITEM IN ANY WAY, IF AN ITEM BEARING THE SEAL OF AN ARCHITECT, ENGINEER, OR LAND SURVEYOR IS ALTERED; THE ALTERING ARCHITECT, ENGINEER, OR LAND SURVEYOR SHALL AFFIX TO THE ITEM THEIR SEAL AND NOTATION "ALTERED BY" FOLLOWED BY THEIR SIGNATURE AND DATE OF SUCH ALTERATION, AND A SPECIFIC DESCRIPTION OF THE ALTERATION.

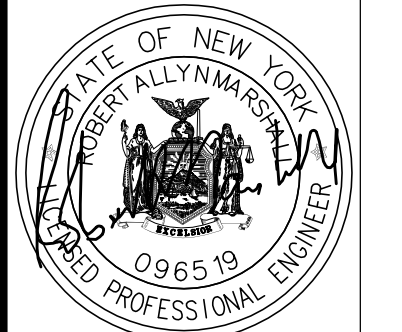

EXP: 06/30/2027

CERTIFICATE OF AUTHORIZATION NUMBER:  
PROFESSIONAL ENGINEERING: 0021272

**CONTRACT:**

**ELECTRICAL**

**TITLE:**  
REPLACE PERIMETER DETECTION & CAMERA SYSTEMS PERIMETER

**LOCATION:**  
ALBION CORRECTIONAL FACILITY  
3595 STATE SCHOOL ROAD  
ALBION, NEW YORK

**CLIENT:**  
DEPARTMENT OF CORRECTIONS  
AND COMMUNITY SUPERVISION

MARK	DATE	DESCRIPTION
△	03/03/2026	ADDENDUM 5
	01/09/2026	BID DOCUMENT
PROJECT NUMBER:	Q1909 - E	
DESIGNED BY:	MJP	
DRAWN BY:	MJP	
FIELD CHECK:		
APPROVED:		

**SHEET TITLE:**  
FIBER PATROL  
CERT GATE DETAILS

**DRAWING NUMBER:**  
ES-504

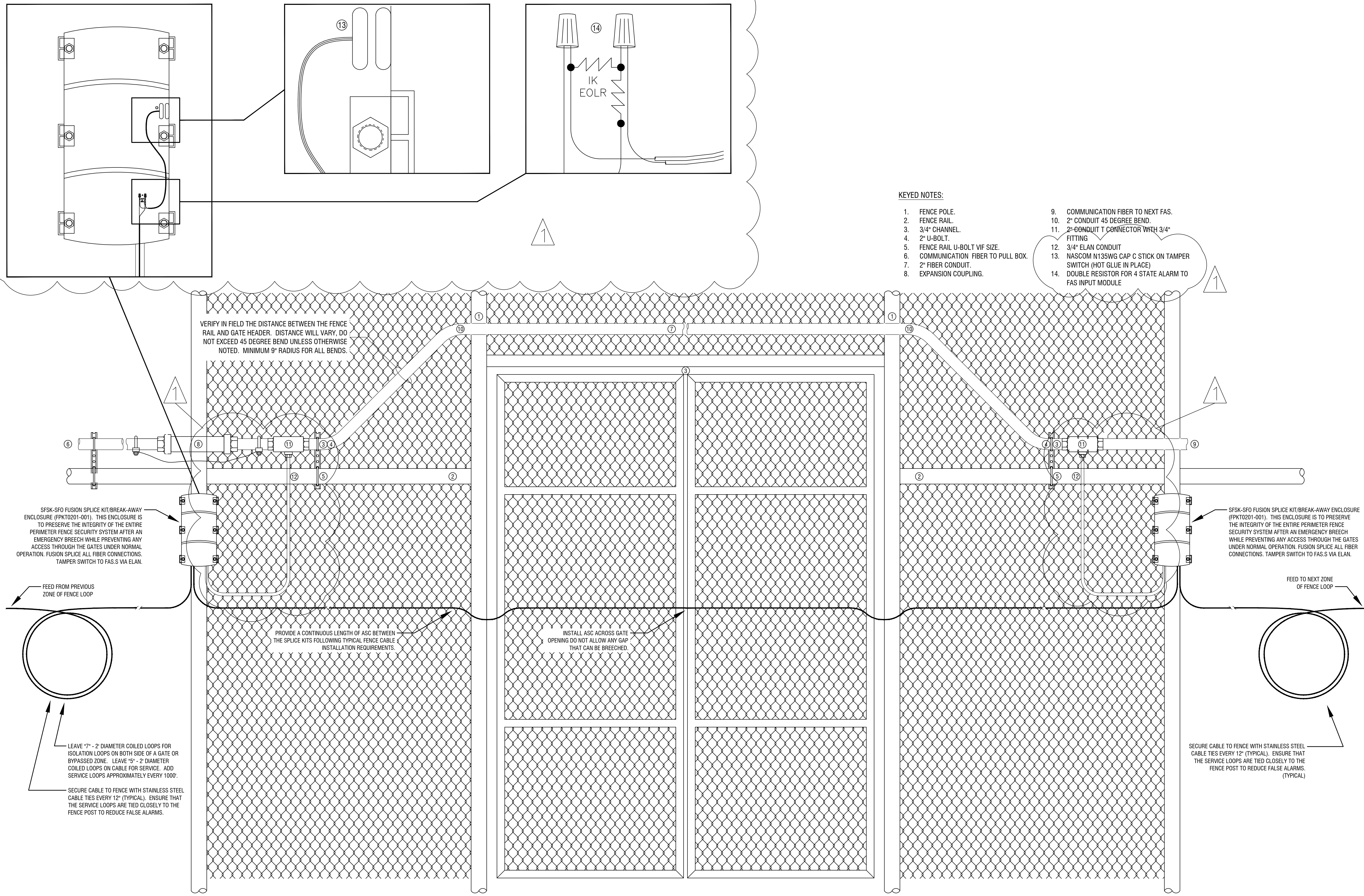

**KEYED NOTES:**

1. FENCE POLE.
2. FENCE RAIL.
3. 3/4" CHANNEL.
4. 2" U-BOLT.
5. FENCE RAIL U-BOLT VIF SIZE.
6. COMMUNICATION FIBER TO PULL BOX.
7. 2" FIBER CONDUIT.
8. EXPANSION COUPLING.
9. COMMUNICATION FIBER TO NEXT FAS.
10. 2" CONDUIT 45 DEGREE BEND.
11. 2" CONDUIT T CONNECTOR WITH 3/4" FITTING.
12. 3/4" ELAN CONDUIT.
13. NASCOM N135WG CAP C STICK ON TAMPER SWITCH (HOT GLUE IN PLACE).
14. DOUBLE RESISTOR FOR 4 STATE ALARM TO FAS INPUT MODULE.

Mar 03, 2026 - 4:07pm  
 B:\GLOBAL\Projects\NYS Office of General Services\2242819.01 - Albion CF Replace Perimeter Detection\06\_Drawings\Electrical\ES-504 - Perimeter Fence Device Details.dwg  
 36x24 PLOT SHEET

**1**  
ES-504  
**FIBER PATROL CERT GATE DETAILS**  
SCALE: NOT TO SCALE